

FLEXIBLES (UK) LTD

PHARMALEX™ PTFE HOSE

Pharmalex hose was designed to provide a lightweight alternative version of Pharmaline hose, for light duty, low pressure applications.

CONSTRUCTION

The same as Pharmaline hose, except there is no SS wire braid, no helix wire, and the platinum cured silicone rubber is transparent, not white. Pharmalex is only available in bore sizes up to 1”.

SPECIFICATIONS FOR PHARMALEX GP AND AS

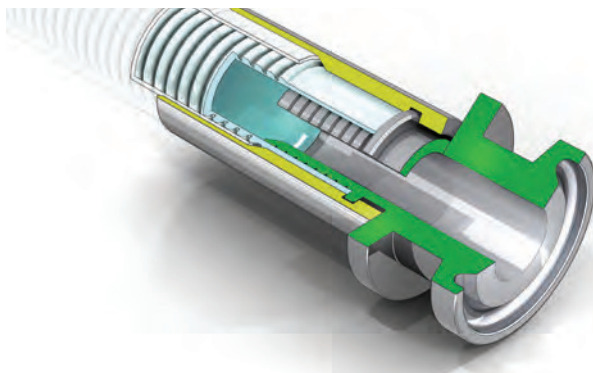

Hose Bore Size		Actual Hose Bore Size		O.D. Over Silicone Cover		Minimum Bend Radius		Maximum Working Pressure		Burst Pressure		Weight per Unit Length		Maximum Continuous Length	
in	mm	in	mm	in	mm	in	mm	psi	bar	psi	bar	lbs/ft	kg/mtr	ft	mtrs
1/4	6.4	0.270	6.8	0.456	11.6	1 1/4	30	109	7.5	435	30	0.06	0.09	60	18
3/8	9.5	0.375	9.5	0.610	15.5	1 1/2	38	87	6.0	348	24	0.06	0.14	60	18
1/2	12.7	0.500	12.7	0.767	19.5	2 1/2	63	84	5.8	334	23	0.14	0.21	60	18
5/8	16.0	0.625	16.0	0.960	24.4	3	75	75	5.0	300	20	0.18	0.27	60	18
3/4	19.0	0.750	19.0	1.070	27.3	4	100	62	4.3	247	17	0.21	0.32	60	18
1	25.4	1.000	25.4	1.370	34.8	6	150	52	3.5	203	14	0.33	0.49	60	18

*Sizes up to 1” are available in continuous lengths up to 120ft (36 mtrs) to special order

PRESSURE TESTING

Before despatch, all hose assemblies are hydrostatically pressure tested to 1.5 times the Maximum Working Pressure of either the hose or the end fitting, whichever has the lower M.W.P. A Test Certificate can be issued if required.

TEMPERATURE LIMITATIONS

The silicone cover limits the maximum service temperature to 392°F, 200°C.

VACUUM LIMITATIONS

Useable at full vacuum up to 285°F, 140°C.